

LEGEND

APPROXIMATE LOCATIONS ONLY OF ZONING DISTRICTS

- COMMERCIAL
- HISTORIC
- INDUSTRIAL
- OFFICE
- RESIDENTIAL
- WATERFRONT INDUSTRIAL

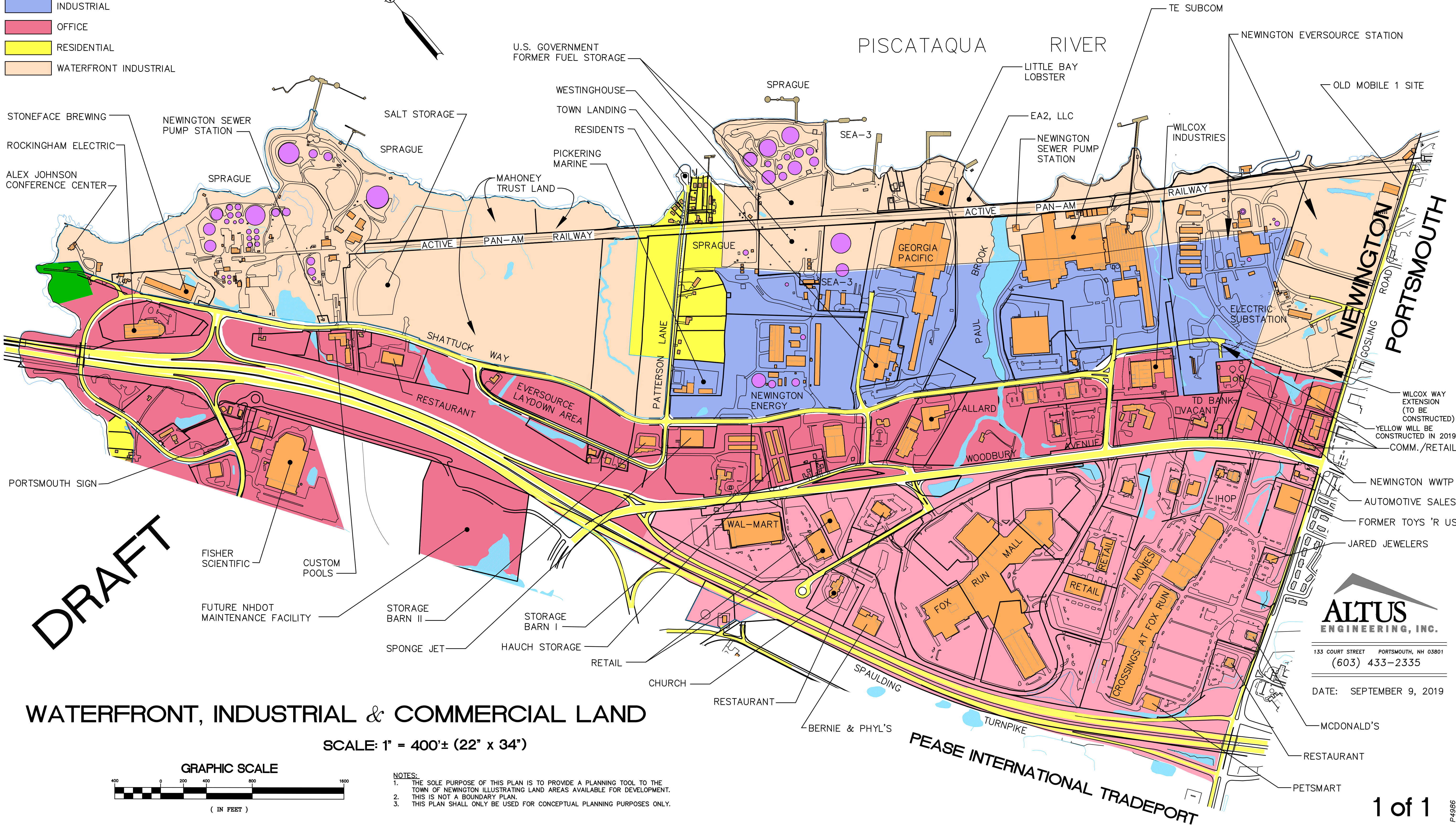
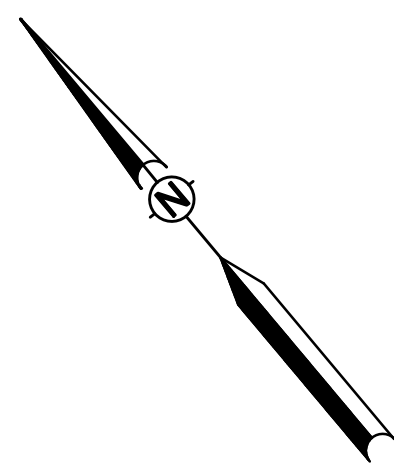

DRAFT

WATERFRONT, INDUSTRIAL & COMMERCIAL LAND

SCALE: 1" = 400'± (22" x 34")

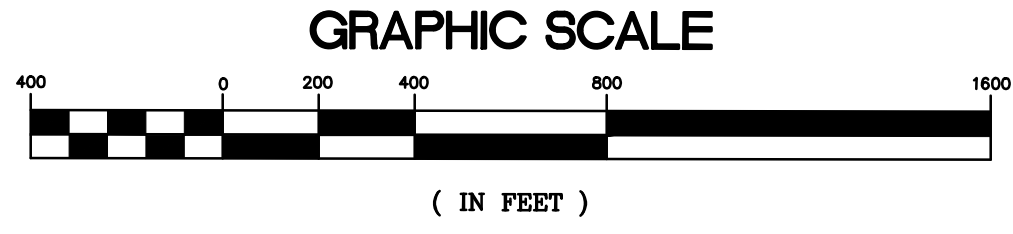

- NOTES:**
1. THE SOLE PURPOSE OF THIS PLAN IS TO PROVIDE A PLANNING TOOL TO THE TOWN OF NEWINGTON ILLUSTRATING LAND AREAS AVAILABLE FOR DEVELOPMENT.
 2. THIS IS NOT A BOUNDARY PLAN.
 3. THIS PLAN SHALL ONLY BE USED FOR CONCEPTUAL PLANNING PURPOSES ONLY.

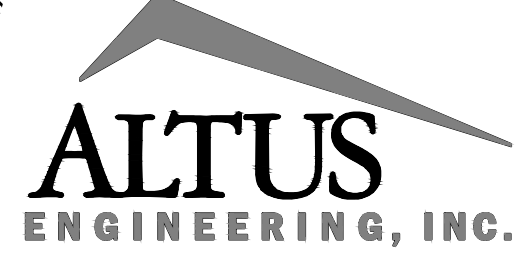

133 COURT STREET PORTSMOUTH, NH 03801
(603) 433-2335

DATE: SEPTEMBER 9, 2019

- MCDONALD'S
- RESTAURANT
- PETSMART